

WASHER DRYER



USER MANUAL

HWD-C1000TXVE-U
HWD-C1200TXVE-U

HWD-C1000TXVE ME-U
HWD-C1200TXVE ME-U



Haier

BEFORE USE

- Important Safety Information . . .03
- Components 04
- Preparation 05
- Safety instructions 06
- Installation07
- Control Panel 09

USING THE APPLIANCE

- Operational functions10
- Program selection 11
- Consumption and technical data12
- Washing & drying13

MAINTENANCE

- Cleaning & Care 17
- Display codes 19
- Trouble shooting20

LEGEND

Yes

No

Optional



For your safety, any instructions in this manual with this "Warning" sign must be followed strictly.

IMPORTANT SAFETY INFORMATION

Do not use a multiple socket extension cord. A separate earthed socket is required which shall be accessible at all times. If the mains cord becomes damaged, it must be replaced by the manufacturer, its service agent or similarly qualified person with a lead of the same type and rating to avoid a hazard.

Never remove the plug from the socket by pulling on the cord, always grasp the plug.

The door may get hot during use, do not touch it and keep children away whilst the machine is operating.

Never open the detergent drawer while the machine is running. Hot water and detergent might be ejected.

When installing the product, make sure the mains cord is not trapped or twisted.

WARNINGS:

THIS APPLIANCE IS INTENDED FOR DOMESTIC USE ONLY, COMMERCIAL OR ANY OTHER USE MAY INVALIDATE THE WARRANTY AND MIGHT BE DANGEROUS.

Never touch or operate the machine with wet hands or when bare footed.

Do not put the machine on a carpet that can block the ventilation slots on the bottom of the unit.

Do not install this machine outdoors or in a damp place or expose it to rain.

Do not install this product near a heat source or in direct sunlight.

Do not place any object on the machine when it is operating.

This appliance must be earthed.

If you are disposing of an old appliance, disable the door lock to avoid entrapment of children when playing and cut off the mains cord close to the machine.

The appliance must be connected to a 220-240 volts 50 cycle AC supply by means of a three pin socket, suitably earthed and should be protected by a 13 amp fuse in the plug.

The appliance is supplied with a standard 13 amp 3-pin plug fitted with a 13-amp fuse. Should the fuse require replacement, it must be replaced with a fuse rated at 13 amps and approved to BS1362.

If the mains plug is unsuitable for the socket outlet in your home or is removed for any other reason, then the cut off plug should be disposed of safely, do not insert the cut off plug into a mains outlet to prevent the hazard of electric shock. Remove the fuse before disposal.

There is a danger of electric shock if the cut off plug is inserted into any 13-amp socket outlet.

How to wire a 13 amp plug. (UK Only)

The wires in the mains lead on this appliance are coloured in accordance with the following code:

Green and Yellow - Earth Blue — Neutral Brown — Live

As the colours may not correspond with the markings identifying the terminals in your plug proceed as follows.

The green and yellow wire must be connected to the terminal in the plug which is marked with the letter E or with the earth symbol or coloured green and yellow.

The blue wire must be connected to the terminal marked N.

The brown wire must be connected to the terminal marked L.

You must make sure the lead is firmly secured under the cord clamp.

WATER CONNECTION

The product should be connected to the water main using new hose sets, old hose sets should not be re used.

The water pressure must not be less than 0.03MPa.

Connect to the water main using a standard 3/4 inch threaded tap outlet.

COMPONENTS

THANKS FOR PURCHASING A HAIER PRODUCT

Please read these instructions carefully before using this appliance. The instructions contain important information which will help you get the best out of the appliance and ensure safe and proper installation, use and maintenance.

Keep this manual in a convenient place so you can always refer to it for the safe and proper use of the appliance. If you sell the appliance, give it away, or leave it behind when you move house, make sure you also pass on this manual so that the new owner can become familiar with the appliance and safety warnings.

ACCESSORIES

Check the accessories and literature in accordance with this list:

1x Inlet hose assembly

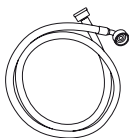

1x Bottom cover (include the feather felt)

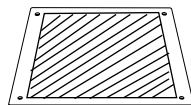

1x Drain hose bracket

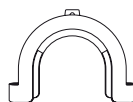

1x Service manual



3x Blanking plugs



PREPARATION

PREPARING THE MACHINE

Remove all the packing materials to prevent unsteadiness, including the polystyrene base.

Upon opening the package, water drops may be seen on the plastic bag and the porthole. This is normal phenomenon resulting from water tests in the factory.

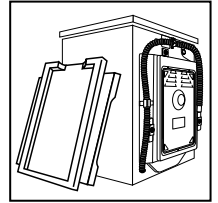

DESCRIPTION

Power switch

Program knob

Door handle

Display

Porthole

Washer door

Detergent distribution drawer

Filter cover

Drain hose

Water inlet valve

Power cord

Back cover

Back cover screws

Transportation bolts

Transom

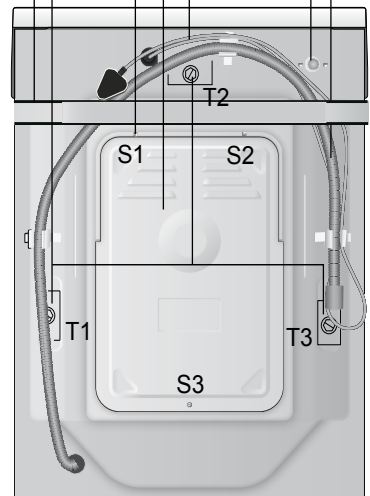
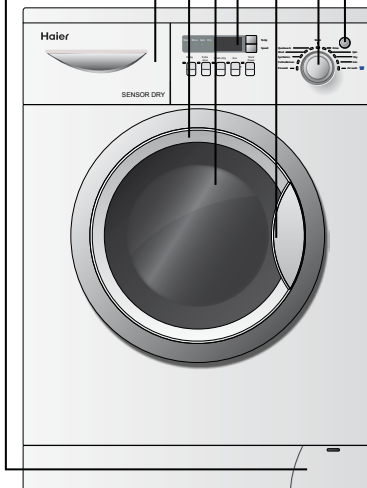

This diagram may be slightly different from the layout of the washer dryer you have just purchased due to technical improvements.



SAFETY INSTRUCTIONS

BEFORE SWITCHING THE APPLIANCE ON FOR THE FIRST TIME

DO ...

- ... ensure you connect the appliance directly to a domestic mains water supply.
- ... make sure that the plug is accessible.
- ... keep surrounding areas free from accumulation of lint, dust and dirt.
- ... keep away from heat sources and direct sun light to prevent plastic and rubber components from aging.
- ... make sure that the power cord is not caught under or in the appliance and avoid damage to the power cord.
- ... ensure that the appliance is not installed behind a lockable door, a sliding door or a door with a hinge on the opposite side to that of the appliance so that a full opening of the appliance door is restricted.
- ... make sure that children or infirm persons do not play with the packing materials.

DO NOT ...

- ... touch or use the appliance when barefoot or with wet or damp hands or feet.
- ... use flammable detergent or dry cleaning agent.
- ... use any flammable sprays in close vicinity to the appliance.
- ... remove or insert the plug in the presence of flammable gas.
- ... install the appliance outdoors in a damp place, or in an area which may be prone to water leaks such as under or near a sink unit. In the event of a water leak allow the machine to dry naturally.
- ... place the washer dryer directly on a carpet, or close to a wall or furniture.
- ... connect the appliance to the power supply until installation is complete.
- ... use an appliance with missing parts.
- ... dry unwashed garments in the washer dryer.

DURING DAILY USE OF THE APPLIANCE

DO ...

- ... make sure that items soiled with cooking oil, acetone, alcohol, petrol, kerosene, spot removers, turpentine, waxes, wax removers or similar substances have been washed with hot water and an extra amount of detergent before being dried.
- ... in case the power cord is damaged, let it be replaced by the manufacturer, his service agent or other accordingly qualified persons.
- ... unplug the appliance before carrying out any maintenance or repair.
- ... hold the plug and not the electric cable when unplugging the power supply.
- ... ensure that the appliance is not used by persons with reduced physical, sensory or mental capabilities, lack of experience and knowledge without supervision or instruction by a person responsible for their safety.
- ... make sure not to place heavy objects or sources of heat or damp on top of the appliance.

DO NOT ...

- ... touch the washer dryer door during the washing or drying process - it gets hot!
- ... hot wash or dry foam rubber or sponge-like materials, shower caps or waterproof textiles.
- ... open the detergent distribution drawer during the wash cycle.
- ... force the washer dryer door open. The door is fitted with a self-lock device and will not open until 2-3 minutes after the washing machine stops.
- ... open the washer dryer door if the water level is visibly over the porthole.
- ... attempt to repair the appliance yourself. Contact the manufacturer or their approved service agent.
- ... stop the washer dryer before the end of the drying cycle unless all items are quickly removed and spread out so that the heat is dissipated.

INSTALLATION

ADJUSTING THE BOTTOM COVER

Before removing the transportation bolts, please fix the bottom cover to the bottom of the washer dryer. Lay down the machine (fig. 1.), screw off the feet and adjust the bottom cover with the four holes corresponding the screw holes of the feet. Then screw the feet back on through the cover and fix it thus securely to the bottom of the machine (fig. 2.).

It keeps out the dampness and reduces the noise.

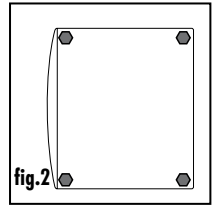
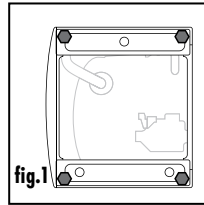

DISMANTLE THE TRANSPORTATION BOLTS

The transportation bolts are designed for clamping anti-vibration components inside of the washer dryer during the transportation process.

1. Remove the back cover.
2. Remove the three bolts on the rear side and take out the synthetic stabilisers from within the machine.
3. Replace the back cover.
4. Fill the holes left by the bolts with blanking plugs.

Note:

1. When you replace the back cover, the convexity must face to outside, and you have to insert the back cover from the two gaps as shown in fig.3.

2. Keep the transportation bolts and synthetic stabilisers in a safe place for later use.

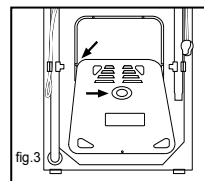
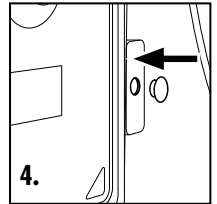
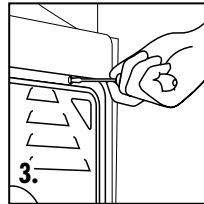
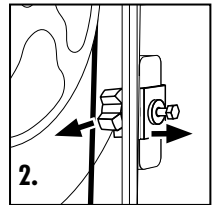
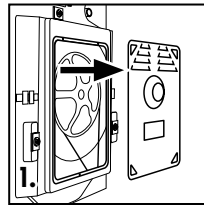

ADJUSTING THE WASHER DRYER

There are adjustable feet under the bottom of the washer dryer. Before use, they should be adjusted so that the machine is level. This will minimise vibrations and thus noise during use. It will also reduce wear and tear. We recommend using a spirit level to level the appliance.

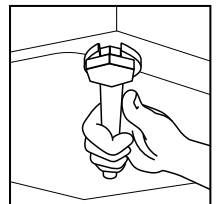

INSTALLATION

INLET HOSE

1. Connect the nut on the inlet hose to the connector on the water valve.
2. Apply inlet hose to a water tap with cold, fresh water.

Note: Use the hose-set supplied with the appliance. Old hose-sets should not be reused.

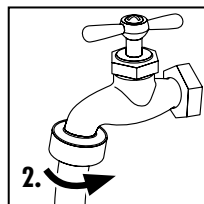
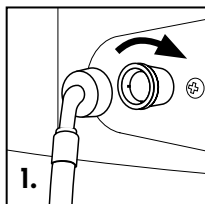

DRAIN HOSE

1. Use the drain hose bracket to keep the end of the drain hose retained and prevent the outflow of water. Don't extend the length of the drain hose; if an extended hose is required, please consult a serviceman.
2. The height of the drainage outlet must be 80-100 cm. Fix the drain hose to the clip at the back of the washing machine to prevent it from dropping off.

Note: The drain hose should not be submerged in water and should be securely fixed and leak-free. If the drain hose is placed on the ground or if the pipe is at a height of less than 80cm, the washing machine will continuously drain while being filled (self-siphoning).

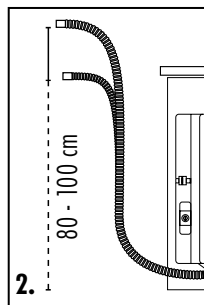
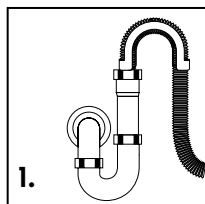

CONNECTING TO THE POWER SUPPLY

Before connecting to the power supply, check:

- The socket is adequate for the maximum power of the Washer Dryer (For safety, fuses in the power circuit should be rated for no less than 15A).
- The voltage should meet the requirement.
- The power outlet should be capable of accepting the Washer Dryer plug.
- Connect the machine to an earthed socket outlet.

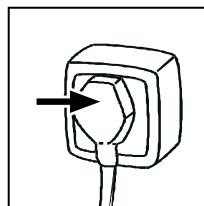

CONTROL PANEL

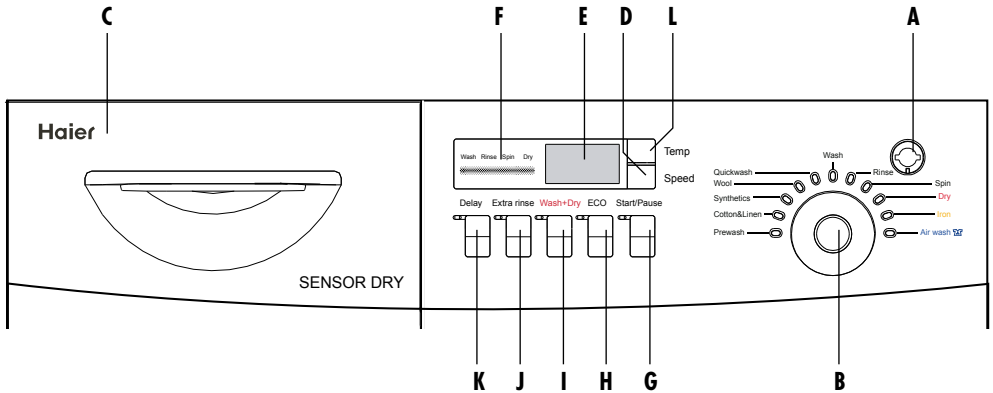

- | | | |
|--|--------------------------------|----------------------------------|
| A Power button | E Display | I Dry button |
| B Program selection dial | F Wash status indicator | J Extra rinse button |
| C Detergent distribution drawer | G Start/Pause button | K Delay button |
| D Spin speed setting button | H Eco button | L Wash temperature button |

See the explanations of the controls on the opposite page.

Wash and Dry(1st 8 settings with green LED's)

Press the ON OFF button then turn the wash program knob to select the required program.

Press the DRY button(before the wash cycle starts)to make the washer enter dry(mode 9)after the wash cycle has finished.

Press the START/PAUSE button to start the Wash/Dry cycle.

NOTE

Pressing the DRY button a second time(Before the wash cycle starts)will turn off the Auto dryer.

Wash Only(1st 8 settings with green LED's)

Press the ON OFF button then turn the wash program knob to select the required program 1-8.

Press the START/PAUSE button to start the wash cycle.

Dry Only(Last 3 settings with Amber LED's)

Press the ON OFF button then turn the wash program knob to select the required program 9-11.

Press the START/PAUSE button to start the wash cycle.

OPERATIONAL FUNCTIONS

- | | | |
|----------|----------------|--|
| A | → Power switch | → Press this button to turn the machine on. Press it again to switch it off. |
| B | → Program knob | → Turn the dial clockwise or anti-clockwise to select the required program. (Refer to program modes on page 10). |

CONTROL PANEL

OPERATIONAL FUNCTIONS

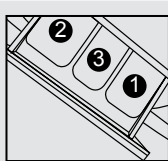
C	→ Detergent distribution drawer	<p>– Instructions are printed on the front of the drawer. Open the drawer, three compartments can be seen:</p> <p>Compartment 1: Pre-wash detergent</p> <p>Compartment 2: Standard washing - extra-fast washing</p> <p>Compartment 3: Softener, conditioning agent, perfume, etc.</p>										
D	→ Spin speed button	– Press this button to select the desired speed.										
E	→ Display	– Information such as remaining wash time, temperature and speed setting and error messages are shown here.										
F	→ Wash status indicator	– This light shows the stage of the cycle in the selected program										
G	→ Start/Pause button	– After the Washer Dryer is connected to the power socket and a program is selected, press this button to start operation. Press this button again during operation to pause the program. The display screen will start blinking and the machine will be paused. Press the button again and the program will continue.										
H	→ Eco button	<p>– Economy wash. This function automatically adjusts water consumption, wash time and heating time. The wash load range is:</p> <table border="0" data-bbox="400 842 1025 938"> <tr> <td>Prewash: 1kg-6kg;</td> <td>Cotton: 1kg-6kg;</td> <td>Synthetic: 1kg-3kg;</td> </tr> <tr> <td>Quick wash: 1kg-3kg;</td> <td>Wash: 1kg-6kg;</td> <td>Rinse: 1kg-6kg;</td> </tr> <tr> <td>Spin: 1kg-6kg;</td> <td>Dry: 1kg-3kg</td> <td></td> </tr> </table>	Prewash: 1kg-6kg;	Cotton: 1kg-6kg;	Synthetic: 1kg-3kg;	Quick wash: 1kg-3kg;	Wash: 1kg-6kg;	Rinse: 1kg-6kg;	Spin: 1kg-6kg;	Dry: 1kg-3kg		
Prewash: 1kg-6kg;	Cotton: 1kg-6kg;	Synthetic: 1kg-3kg;										
Quick wash: 1kg-3kg;	Wash: 1kg-6kg;	Rinse: 1kg-6kg;										
Spin: 1kg-6kg;	Dry: 1kg-3kg											
I	→ Dry button	– Press this button, the corresponding light will go on and the appliance will dry the laundry after the last spin cycle.										
J	→ Extra rinse button	<p>– Press this button, the overhead indicator will go on. An additional rinse operation will be activated.</p> <p>Note: Select this function when programme 1-6 or 9 is selected.</p>										
K	→ Delay button	<p>– Press the button repeatedly before starting the program to enter the time you want the machine to be finished in, the start will delay from 0.5 to 24 hours in 30-minute intervals. After the delay is selected, press the Start/Pause button to start countdown (the time is displayed on the screen until the programme ends). Note: The delay time must be longer than the programme time, otherwise the Washer Dryer will start the wash programme immediately.</p>										
L	→ Wash temperature button	– Touch this button and the wash temperature will be displayed on the screen. Select a suitable temperature according to the type of laundry.										

PROGRAM SELECTION

PROGRAM MODES

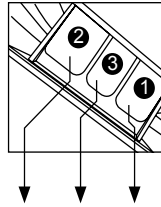

- 1 Detergent compartment for prewash mode
- 2 Detergent compartment
- 3 Compartment for softener and other additives

PROGRAM	TEMPERATURE		2	3	1	RECOMMENDED LAUNDRY	DEFAULT SPIN SPEED
	MAXIMUM	PRESET					
1 – Prewash	0 ° to 90 °C	40 °C	<input checked="" type="checkbox"/>	<input type="checkbox"/>	<input checked="" type="checkbox"/>	Heavy soiled laundry	1000 rpm
2 – Cotton & Linen	0 ° to 90 °C	40 °C	<input checked="" type="checkbox"/>	<input type="checkbox"/>	<input checked="" type="checkbox"/>	Cotton fabrics	1000 rpm
3 – Synthetics	0 ° to 60 °C	40 °C	<input checked="" type="checkbox"/>	<input type="checkbox"/>	<input checked="" type="checkbox"/>	Synthetic fabrics	800 rpm
4 – Wool	0 ° to 40 °C	0 °C	<input checked="" type="checkbox"/>	<input type="checkbox"/>	<input checked="" type="checkbox"/>	Wool fabrics	600 rpm
5 – Quick wash	0 ° to 40 °C	40 °C	<input checked="" type="checkbox"/>	<input type="checkbox"/>	<input checked="" type="checkbox"/>	Lightly soiled cotton, linen and synthetic fabrics	800 rpm
6 – Wash	0 ° to 60 °C	40 °C	<input checked="" type="checkbox"/>	<input type="checkbox"/>	<input checked="" type="checkbox"/>	Cotton, linen and synthetic fabrics	/
7 – Rinse	0 °C	40 °C	<input checked="" type="checkbox"/>	<input type="checkbox"/>	<input checked="" type="checkbox"/>	Cotton, linen and synthetic fabrics	800 rpm
8 – Spin	0 °C	0 °C	<input checked="" type="checkbox"/>	<input checked="" type="checkbox"/>	<input checked="" type="checkbox"/>	Cotton, linen and synthetic fabrics	1000 rpm
9 – Dry	The laundry is completely dry when the cycle is complete					Cotton, linen and synthetic fabrics	/
10 – Iron	The laundry is completely dry when the cycle is complete					Cotton, linen and synthetic fabrics	/
11 – Air wash	Air refresh wash for small items that need a quick refresh (e.g. school uniforms)					Cotton, linen and synthetic fabrics	/

Yes

No

Optional

CONSUMPTION AND TECHNICAL DATA

CONSUMPTION TABLE

The wash cycle times are intended as a guide only. The actually used time may vary due to different water pressure, initial water temperature, etc.

PROGRAM	ENERGYCONSUMPTION	WATERCONSUMPTION	WASHING TIME
→ Prewash	0.637 kw/h	68.3 l	133 min.
→ Cotton & Linen	0.482 kw/h	58.4 l	133 min.
→ Synthetics	0.288 kw/h	34.1 l	72 min.
→ Wool	0.225 kw/h	30.8 l	60 min.
→ Quick wash	0.018 kw/h	30.4 l	12 min.
→ Wash	0.341 kw/h	12.1 l	61 min.
→ Rinse	0.038 kw/h	32.7 l	24 min.
→ Spin	0.033 kw/h	0 l	11 min.
→ Dry	4.227 kw/h	111.4 l	150 min.
→ Iron	0.888 kw/h	23.5 l	60 min.
→ Air wash	0.446 kw/h	11.76 l	30 min.

TECHNICAL DATA

	HWD-C1000TXVE-U HWD-C1000TXVEME-U	HWD-C1200TXVE-U HWD-C1200TXVEME-U
Power source	220 - 240V~/50Hz	220 - 240V~/50Hz
Max. working current (A)	10	10
Water pressure (MPa)	$0.03 \leq P \leq 1$	$0.03 \leq P \leq 1$
Washing power (W)	200	200
Spinning Power (W)	350	450
Spinning speed (r/min)	1000	1200
Max. load (kg)	6	6
Washing programs	11	11
Water heating power (W)	1800	1800
Dry heating power (W)	1000	1000
Dimensions (HxDxW mm)	850 x 590 x 595	850 x 590 x 595
Net weight (kg)	82	82
Washing noise (dB A)	54,3	54,3
Spinning noise (dB A)	71,8	71,8

WASHING & DRYING

POWER SUPPLY

Connect the washer dryer to the power supply (220V to 240V~/50Hz).

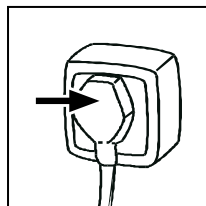

WATER CONNECTION

Turn on the tap. The water must be clean and clear.

Note: Before use, check for leakage in the joints between the tap and the inlet hose by turning on the tap. Do not use the appliance until the hoses are properly fixed.

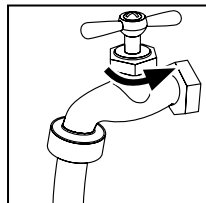

PREPARING THE LAUNDRY

- Sort out clothes according to fabric (cotton, synthetics, wool or silk) and to how dirty they are.
- Separate white clothes from coloured ones. Wash them first by hand to check if they fade or run.
- Empty pockets from objects like lighters and matches, keys, coins, etc. and remove the harder decorative objects (e.g. brooches).
- Garments without hems, underwear, finely woven textile such as fine curtains are to be put into wash bag (it is better not to wash them in a washing machine).
- Close zippers and hooks, make sure the buttons are sewn on tightly and place small items such as socks, belts, bras, etc. in the wash bag.
- Unfold large pieces of fabric such as bed sheets, bedspreads, etc.
- Turn shirts inside out.

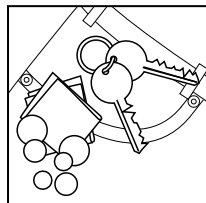
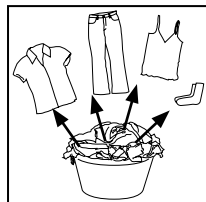

PLEASE NOTE

This Washer Dryer is for domestic use only. Do not use it for purposes other than that for which it was designed. Follow the instructions given on the label of each garment and wash only machine-washable garments. Do not dry garment that has been cleaned with industrial chemicals.



WASHING&DRYING

LOADING THE MACHINE

Open the washer door, put in the laundry piece by piece. Close the door tightly.

- When first using the Washer Dryer, let it run empty without detergent for one quick wash cycle to prevent the laundry from being tainted by oil or dirty water from the Washer Dryer.
- Do not overload the Washer Dryer.

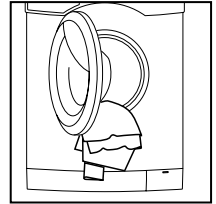

SELECTING DETERGENT

The washing efficiency and the performance is determined by the quality of detergent used. Special non-foaming detergent produces good washing results. Use specific detergents for synthetic and woollen goods. Do not use dry cleaning agents such as trichloroethylene and similar products.

Note: Do not add more detergent than needed. Please follow the dosage recommendation on the detergent package.

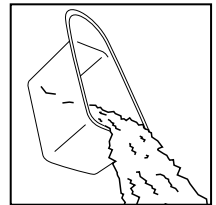

ADDING DETERGENT

Slide out the detergent drawer and put the required detergent and softening agent into the corresponding compartments. Push back the drawer gently. (Refer to the instructions on the drawer)

Caution:

- For pre-washing program, detergent should be added to both compartments 1 and 2. For other programs, do not add detergent to compartment 1.
- If liquid detergent will be used, please fill in to the dosage cup and place it directly into the drum together with the laundry.
- Do not overuse softener; otherwise, it will damage the artificial fibers.

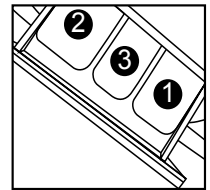

SELECTING PROGRAM

To get the best washing results, an appropriate washing program should be selected according to the laundry type. Please turn the program knob clockwise to select the right program.

SELECTING FUNCTIONAL

Select the required options. (Refer to the "Control panel" pages 09 and 10). Otherwise keep all the buttons deselected. If you wish to dry your laundry directly after the wash cycle is finished, please press the "Dry"-button.

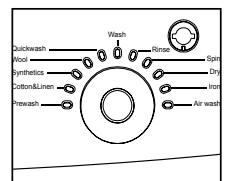

WASHING & DRYING

SETTING WASHING TEMPERATURE

Press and hold down the temperature button until the desired temperature is selected or the symbol  for no water heating.

SETTING SPIN SPEED

Press and hold down the speed button until the desired speed is selected or the symbol  is selected for no spin. See "Operational functions" on the "Control panel" pages (09 and 10) for selecting temperature and spin speed. It is advisable to select the recommended value.

WASHING

Press the Start/Pause button. The Washer Dryer will operate according to the pre-set programs. The Washer Dryer will stop operation automatically when a washing cycle ends. The "End" sign will appear on the display. Open the washer door and take out the laundry.

DRYING

If you wish to dry wet laundry, please select one of the drying programs by turning the program knob (Refer to the "Control panel" pages 09 and 10).

AFTER USING THE APPLIANCE

Turn off the water supply and unplug the power cord. Open the washer door to prevent formation of moisture and odours. Let the door open while not used.





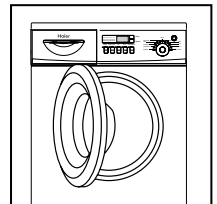
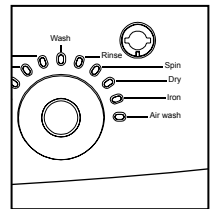
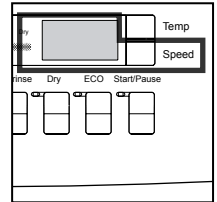
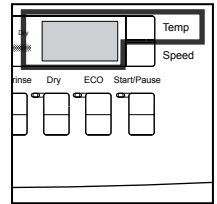









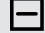













TIPS FOR SAVING ENERGY

1. Collect clothes for one full wash load.
2. Avoid overloading the washer dryer.
3. Pre-wash only heavily soiled clothes.
4. Reduce the amount of detergent or choose the speed up wash programs for slightly soiled clothes.
5. Choose a proper washing temperature. Modern detergents can wash with very good result already in lower temperature than 60°C. Only user higher temperature than 60° for heavily soiled laundry.
6. Follow the dosage recommendation on the detergent package to avoid using too much detergent.
7. Softening agent makes clothes feel softer and easier to iron.
8. Adding fabric conditioner will also get rid of static condensation to make ironing easier.



WASHING & DRYING

CARE CHART

	Resistant material		Bleachable in cold water		Don't dry clean	
	Delicate fabric		Do not bleach		Dry flat	
		Washable at 95° C		Iron at 200° C		Hung to dry
		Washable at 60° C		Iron at 150° C		Dry on clothes hanger
		Washable at 40° C		Iron at 100° C		Tumble dry, normal heat
		Washable at 30° C		Don't iron		Tumble dry, reduced heat
	Hand wash		Dry cleaning (any solvent)		Don't tumble dry	
	Dry clean only		Dry cleaning (perchloride)			
	Wool Seal		Dry cleaning (aviation fuel)			

WASH LOAD

Cotton: 6 kg

Synthetic: 3 kg

Delicate: 2 kg

Quick: 3 kg

LOAD REFERENCE

Bed sheet (single)	Cotton	Approximately 800g
Blanket	Wool	Approximately 3000g
Blended fabric clothes	/	Approximately 800g
Jackets	Cotton	Approximately 800g
Jeans	/	Approximately 800g
Overalls	Cotton	Approximately 950g
Pyjamas	/	Approximately 200g
Shirts	/	Approximately 300g
Socks	Blended fabrics	Approximately 50g
T-Shirts	Cotton	Approximately 300g
Underwear	Blended fabrics	Approximately 70g

PLEASE NOTE

The final part of a drying cycle is a cooling cycle without heat to ensure that the dried items are left at a temperature that keeps them undamaged.

CLEANING & CARE

AFTER WASHING

Turn off the water supply and pull out electricity plug after each wash. Open the washer dryer door to prevent formation of moisture and odours. If the washing machine is left idle for a long period, drain the water in the machine and replace the drain hose.

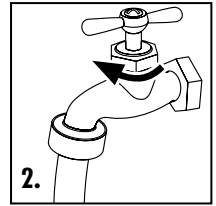
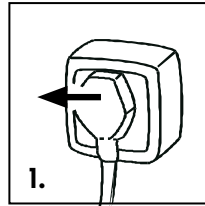

CLEANING THE DETERGENT DRAWER

Clean the detergent distribution drawer regularly.

Swing out the drawer, flush it clean with water and then replace it.

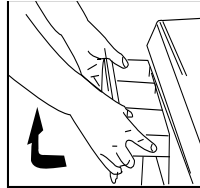

CLEANING THE MACHINE

Unplug the machine during cleaning and maintenance. Use a soft cloth dampened with soap liquid to clean the machine case and rubber components. Do not use organic chemicals or corrosive solvents.

CLEANING THE FILTER

Clean the filter once a month:

1. Open the bottom cover.
2. Remove the filter by turning counterclockwise.
3. Flush the filter clean with running water.
4. Replace the filter by turning clockwise and remount the cover.

Caution:

1. The filter must be in place, or it may lead to leakage.
2. Place a container under the drain pump filter, to collect any excess water that may come out of the drain pump when the filter is removed.

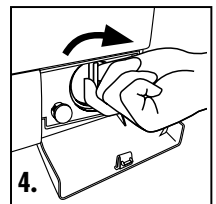
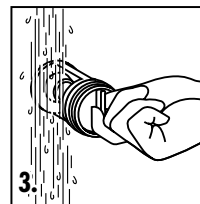
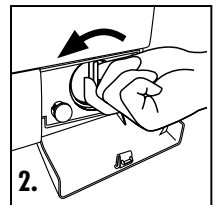
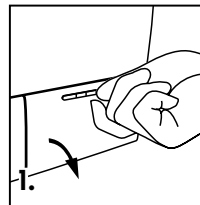

CLEANING & CARE

WATER INLET AND INLET FILTER

To prevent blockage to the water supply by ingress of foreign substances, clean the water inlet and inlet filter regularly.

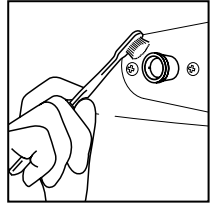

MOVING THE MACHINE

If the machine is to be moved to a distant location, replace the transportation locks removed before installation to prevent damage as shown below.

1. Remove the blanking plugs.
2. Remove the back cover
3. Insert the synthetic stabilisers and the transportation bolts.
4. Tighten the bolts with a spanner.
5. Replace the back cover.

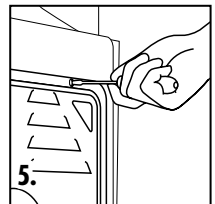
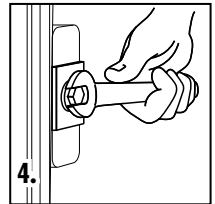
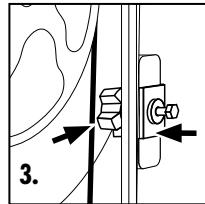
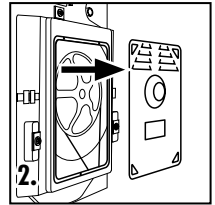
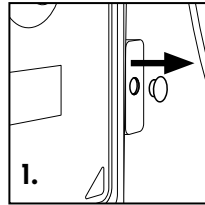

LONG PERIODS OF DISUSE

If the washer dryer is left idle for a long period, pull out the electrical plug and turn off the water supply. Open the washer dryer door to prevent formation of moisture and odours. Let the door open while not used.

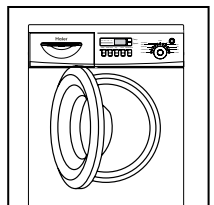

DISPLAY CODES

DISPLAY CODES AND SPECIAL FUNCTIONS

CODES	CAUSES	SOLUTIONS
Err1	→ Washer door is not properly shut.	– Shut the door properly
Err2	→ Drainage error. Water is not emptied within 4 minutes.	– Clean the filter and check the drain hose for blockage. Remove filter in case any water remains in the unit.
Err3	→ Temperature sensor error.	– Please contact the Service Center.
Err4	→ Heater error or laundry overload. The set temperature is not reached within specified time. (Appears at the end of a cycle).	– Reduce load and start washing again. – Please contact the Service Center.
Err5	→ Water level not met within 8 minutes.	– Check the tap and the water pressure.
Err6	→ Dehumidification/heating error.	– Please contact the Service Center.
Err7	→ Motor overheat error.	– Please contact the Service Center.
Err8	→ Water overflow.	– Please contact the Service Center.
Err9	→ Error of the dryer temperature sensor.	– Please contact the Service Center.
Err10	→ Error of the water level sensor.	– Please contact the Service Center.
Err12	→ Error of the dryer water level sensor.	– Check whether clothes are dry or not and whether there is water still in the drum. If so allow excess humidity to escape from the appliance and try the drying cycle again.
Err13	→ Dryer heater error.	– Please contact the Service Center.
Unb	→ Laundry is unevenly distributed.	– Redistribute laundry to balance the drum.
EUAr	→ Communication error.	– Please contact the Service Center.
1:16	→ Status information: remaining program time is 1 hour and 16 minutes.	
0:01	→ Status information: remaining program time is 1 minute.	
60°C	→ Status information: Wash temperature is 60°C.	
-°C	→ No heat (cold wash).	
0	→ No spin.	
800	→ Status information: Spin speed 800 rpm.	
L-1	→ Manually selected code when laundry weight is less than 1kg.	
L-A	→ Manually selected code when drum is nearly full.	
End	→ Program is finished.	

→ **Control panel lock function:** Press the "Delay" and the "Start/Pause" buttons simultaneously for 3 seconds after starting a program. It can no longer be changed by operating buttons or knobs. The washing machine emits an audible signal while the control panel is locked. To unlock press the "Delay" and "Start/Pause" buttons again for 3 seconds.

→ **Power-off memory function:** In case of abrupt power failure or the need to cut off the power during a program cycle, the present settings will be saved and the preset operation will resume when the power is on again.

→ **To cancel a program or select a new program and options during the wash cycles:**

Press the "Start/Pause" button, then switch off the power and the program is automatically cancelled. Turn the program selector again to choose another program.

TROUBLE SHOOTING

TROUBLESHOOTING

In the unlikely event of difficulties with your appliance please follow the troubleshooting guide below. If the problem persists, contact the retailer if the machine is still within the guarantee period. If the appliance is out of guarantee, contact an approved service agent on 0845 025 3025. If an error code is displayed, please refer to the error code guide below.

PROBLEMS	POSSIBLE CAUSES	POSSIBLE SOLUTIONS
Washer Dryer fails to operate.	<ul style="list-style-type: none"> → Poor connection to the power supply. → Power failure. → The washer door is not properly closed. → Machine has not been switched on. 	<ul style="list-style-type: none"> – Check connection to the power supply. – Check the power supply. – Make sure the washer door is closed properly. – Make sure the machine is switched on.
Washer Dryer cannot be filled with water.	<ul style="list-style-type: none"> → Water tap is not turned on. → Water pressure is less than 0,03 MPa. → The inlet hose is kinked. → Water supply failure. → The program knob is not properly set. → The washer door is not properly closed. 	<ul style="list-style-type: none"> – Turn water tap on. – Check water pressure. – Check the inlet hose for bends. – Ensure the water supply. – Make sure the program knob is properly set. – Make sure the washer door is closed properly.
Machine is continually filling and draining.	<ul style="list-style-type: none"> → The height of the drain hose is below 80 cm. → The drain hose is in water. 	<ul style="list-style-type: none"> – Make sure the height of the drain hose is within 80 - 100 cm. – Make sure the drain hose is not in water.
Drainage failure.	<ul style="list-style-type: none"> → Drain hose is blocked. → Drain hose end is more than 100 cm above the floor level. → The filter is blocked. 	<ul style="list-style-type: none"> – Unblock the drain hose. – Make sure the drain hose end is less than 100 cm above floor level. – Unblock the filter.
Strong vibration while spinning.	<ul style="list-style-type: none"> → Not all transportation bolts have been removed. → Washer dryer is located on an uneven surface or is not level. → Machine is overloaded. 	<ul style="list-style-type: none"> – Check if all transportation bolts have been removed. – Make sure the washer dryer is on an even surface and levelled. – Reduce amount of laundry in the drum.
Operation stops before completing wash cycle.	<ul style="list-style-type: none"> → Water or electricity failure. 	<ul style="list-style-type: none"> – Check the power supply.
Operation stops for a period of time.	<ul style="list-style-type: none"> → Washer dryer gives an error message. 	<ul style="list-style-type: none"> – Wait until cycle is complete – See display codes on previous page.
Excessive foam in the drum.	<ul style="list-style-type: none"> → The detergent is not a low-foaming type or for manual wash. → Excessive use of detergent. 	<ul style="list-style-type: none"> – Check if your detergent is appropriate. – Reduce amount of detergent used.
Automatic adjustment of the washing time.	<ul style="list-style-type: none"> → The washing program duration will be adjusted according to the initial water temperature. 	<ul style="list-style-type: none"> – This is normal and doesn't affect the functionality.
Spinning fails	<ul style="list-style-type: none"> → Unbalance of the laundry 	<ul style="list-style-type: none"> – Add clothes or run a spinning program again.

IMPORTANT DISPOSAL INSTRUCTIONS



As a responsible retailer we care about the environment. As such we urge you to follow the correct disposal procedure for your product and packaging materials.

This will help conserve natural resources and ensure that it is recycled in a manner that protects health and the environment.

You must dispose of this product and its packaging according to local laws and regulations.

Because this product contains electronic components, the product and its accessories must be disposed of separately from household waste when the product reaches its end of life.

Contact your local authority to learn about disposal and recycling. The product and packaging should be taken to your local collection point for recycling. Some collection points accept products free of charge.

We apologise for any inconvenience caused by minor inconsistencies in these instructions, which may occur as a result of product improvement and development.

KESA ELECTRICALS U.K HU1 3AU 01/07/2009

Haier

Haier Europe Trading S.r.l.
Via De Cristoforis 12
21100 Varese - Italy

Tel +39 0332 24511
Fax +39 0332 245146
E-mail het.srl@haiereurope.com